

Quick Guide

CB-75

+ COLLABORATIVE + INTERACTIVE + PERSONAL + INTEGRATED + DYNAMIC + ENGAGING +



NOTE: It is the responsibility of the service technician to understand ethernet protocol for setting up Calypso products and to correctly secure cables of proper length.

1

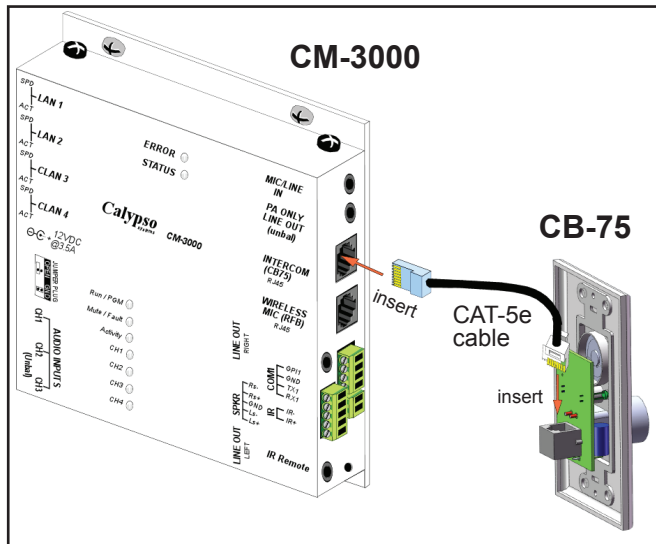

Connect the CAT-5e cable to the CB-75 by inserting and snapping into place the connector end. Assure the other end of the ethernet cable is connected to the INTERCOM (CB75) port on the CM-3000 (refer to the illustration above).

2

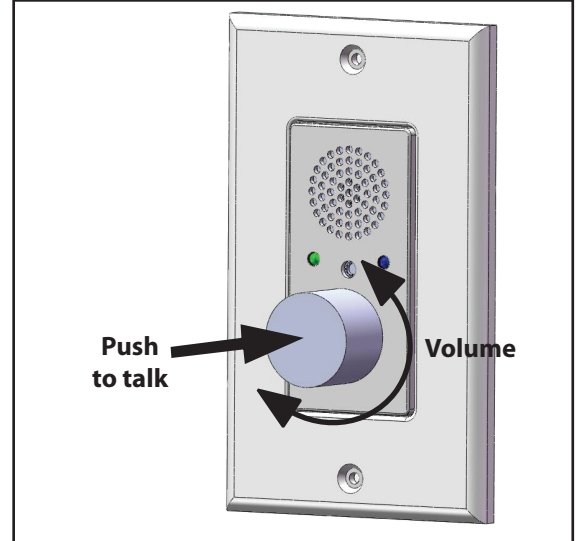

Once the connections to the CB-75 and CM-3000 are made (amplifier needs to also be hooked up), turn the control dial to test the volume and sound. Push and hold the button in to talk. Release the button when you are done talking.

What's in the Box

1

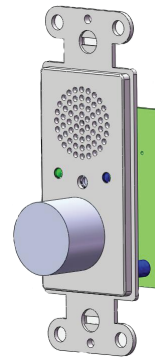

2

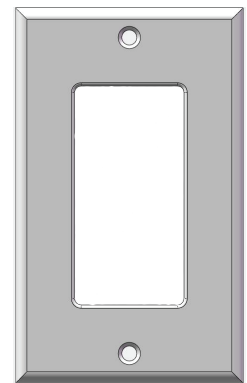

Components included in the box are depicted above and listed from left to right: (1) one CB-75 volume knob assembly, and (2) one decora wall cover plate.